

LEISTER Triac PID

Hot Air Blower



Read operating instructions carefully before use and keep it for further reference.

APPLICATION

- **Welding** of thermoplastic materials as well as single-ply flexible plastics and modified bitumen in the form of boards, tubes, profiles, lining membranes, coated materials, films, foams, tiles, and sheets. The following procedures are possible: overlap welding, welding with rod, with tape, butt welding and melt welding
- **Heating-up** for forming, bending and sealing of thermoplastic semi-finished materials and plastic granules
- **Drying** of water-damp surfaces
- **Shrinking** of heat-shrink sleeves, films, tapes, solder sleeves and moulded parts
- **Soldering** of copper pipes, solder joints and metal foils
- **Defrosting** of frozen water pipes
- **Activating/dissolving** of solvent free adhesives and fusion adhesives
- **Igniting** of wood shavings, paper, coal or straw

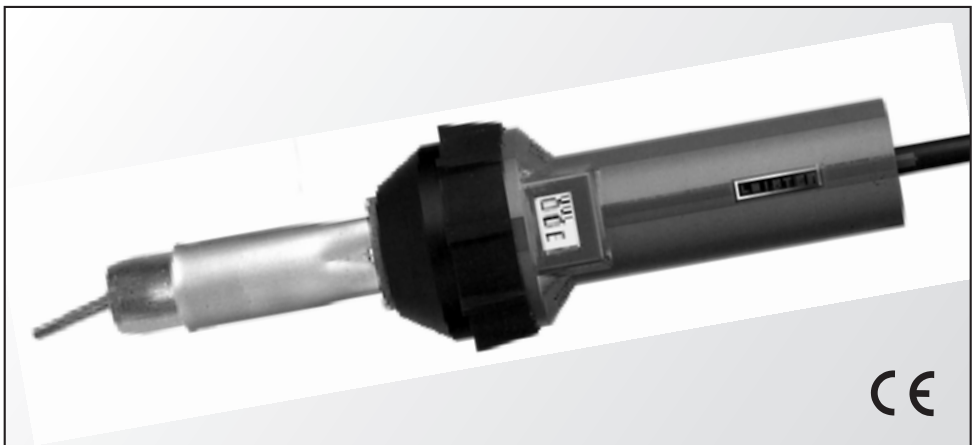



WARNING



Danger to life when opening the tool, as live components and connections are exposed. Unplug the tool before opening it.



Incorrect use of hot air blowers can cause **fire and explosion hazard**, especially near combustible materials and explosive gases.



Do not touch the element housing and nozzle when they are hot as they can cause **burns**. Let the tool cool down. Do not point hot air flow in the direction of people or animals.



CAUTION



The **voltage rating** stated on the tool must correspond to the line/mains voltage.



For personal protection on building sites we **strongly recommend** the tool be connected to a **GFCI** (Ground Fault Circuit Interrupter) or a **RCCB** (Residual Current Circuit Breaker).



The tool must be operated **with supervision**. Warmth can reach combustible materials, which are out of sight.



Protect tool from **damp** and **wet**.

APPROVAL MARKS



This tool is **CCA** certified (CENELEC Certification Agreement).

TECHNICAL DATA

Electrical safety: **DOUBLE INSULATED**

Voltage	V~	42, 100, 120, 200, 230, for 50/60 Hz
Power consumption	W	960, 1400, 1600, 1400, 1600
Temperature	°C	50 – 600, infinitely controlled
Air flow	l/min.	200
Air pressure	Pa	ca. 3000 (30 mbar), after ca. 24 h operating time
Weight	kg	1,4 with 3m cord
Size	mm	Ø 100 x 340, Handle Ø 56

Line/mains voltage cannot be switched over

Description of the tool

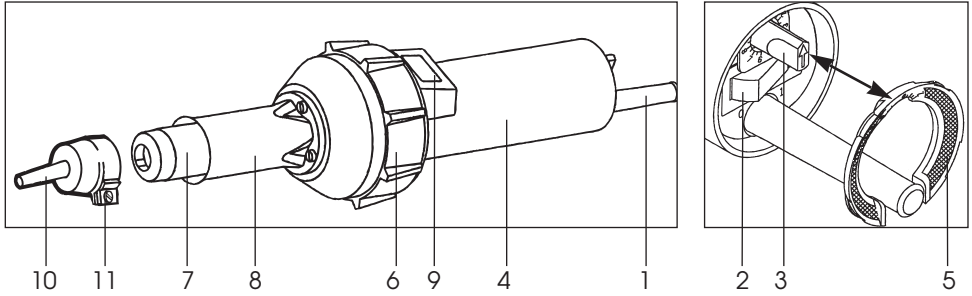

- | | |
|---|--|
| 1. Power supply cord | 6. Rubber stand |
| 2. Main switch | 7. Heater tube |
| 3. Potentiometer for temperature adjustment | 8. Cool protection tube |
| 4. Handle | 9. Digital display of SET and ACTUAL value |
| 5. Air filter | 10. Nozzle |
| | 11. Screw on the clamp |

Digital display (9)



ACTUAL value
SET value

Resolution 2/3°C, 5°F



Sensor error

when max. temperature is exceeded in build-up phase

Readiness for working

- Fit appropriate nozzle as required.
- Connect tool to the line/mains.
- Switch on **main switch (2)**.
- Adjust the hot air temperature by using the **potentiometer (3)** and heat up the tool for approximately 5 minutes.

The temperature can be checked with a thermocouple about 5 mm inside the nozzle, when using round nozzles in the centre of the nozzle, when using draw nozzles in the main nozzle opening. The diameter of the thermocouple must not be more than 1 mm max. (in accordance with DVS 2208 part II).

Operation

- The LEISTER company as well as the Service Centers offer free training courses and advice in all areas of application (see page 1).
- Cool down the tool after use.

Change of nozzles

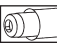
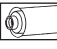
- Cool down the tool. Changing nozzles and use only pliers/screw-driver/fork.
- Do not touch hot **nozzle (10)** and make sure to place it on a heat resistant surface, because of fire hazard.
-  Slide the **nozzle (10)** on the **heater tube (7)** and fix the nozzle by the **screw on the clamp (11)**.
-  Screw the **nozzle (10)** and secure by fork wrench.
- Use only LEISTER nozzles.

VERSIONS

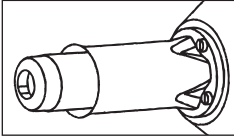

Heater tube with cooled protection tube for LEISTER **push-fit nozzles**

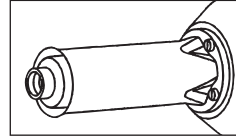

Heater tube with cooled protection tube for LEISTER **screw-on nozzles**

ACCESSORIES

- Use only LEISTER accessories.

MAINTENANCE

- Clean polluted **air filter (5)** with a small brush or replace it.
- Clean welding nozzle or draw nozzle with a steel brush.

SERVICE AND REPAIRS

- By minimal length of the carbon-brushes the motor switch off automatically. Tool have to checked by your Service Center. The life of the brushes are about 1600 running hours of the welding tool's motor.
- Repairs should only be carried out by authorised **LEISTER Service Centres**. They guarantee a specialised and reliable **Repair Service within 24 hours** using original spare parts lists.

GUARANTEE AND LIABILITY

- Guarantee and liability are in accordance with the guarantee certificate as well as with the currently valid general business and sales conditions.
- LEISTER Process Technologies rejects any guarantee claims for tools which are not in their original condition. The tools must never be altered or changed.

Technical data and specifications are subject to change without prior notice.

Authorized Service Center: STAR Process Heat Systems, NJ: 877-782-7747